

# Nero® Collection



We take the worry out of  
protecting what's valuable to you.  
Lockwood: *no worries*®



ASSA ABLOY

[www.lockweb.com.au](http://www.lockweb.com.au)

# NERO® COLLECTION



Master the Mood  
with Lockwood

*The Lockwood Nero Collection provides a sensuous  
quality that complements contemporary décor;  
adding a defining design element to any space.*

# Contents



**143**  
Entrance Handle  
page 4



**Velocity® Large Rose**  
Element Lever  
page 6



**Velocity® Small Rose**  
Leversets  
page 9



**Velocity® Small Rose**  
Escutcheons  
page 13



**Cavity Sliding**  
Door Lock  
page 15



**FP2**  
Flush Pull  
page 17



**724 Series**  
Slide Arm Door Closer  
page 19



**Nexion® Mechanical**  
Entrance Lockset  
page 21



**Paradigm® 005**  
Double Cylinder Deadbolt  
page 25



**Symmetry®**  
Leverset  
page 29

# 143 Entrance Handle



The Lockwood 143 Entrance Handle is constructed using the finest materials to incorporate the maximum standards in style, durability, finish and design.

## Style and Variety

Combining fit for purpose with the epitome of style, the Lockwood 143 Entrance Handle offers a high quality solution to the requirements of both residential and commercial markets.

## Packaging For Various Doors

Comes supplied with spigots to suit 10 – 12mm thick glass doors as well as aluminium and timber doors up to 50mm thick.

## Application

Suitable for use on timber or aluminium frame as well as glass doors; making them the ideal choice for commercial, industrial and residential applications.

**Multi Fix - timber, aluminium or glass doors**

## Product Details

### Materials

Stainless Steel Construction: Constructed of 304 grade stainless steel, suitable for use in external environments

## Standards and Compliance



Disabled Access - AS1428.1

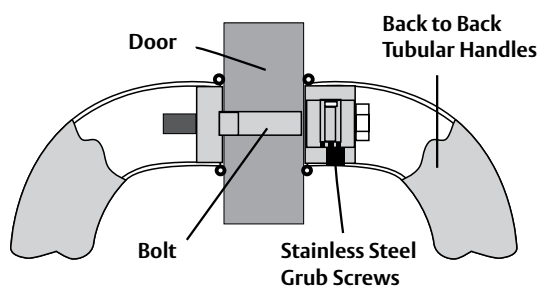

# 143 Entrance Handle

## 143 Entrance Handle

**Part Number** 143X600MBK

### Fixing

**Timber** 2 x 62mm M6 Bolts - 8.5mm hole

**Glass** 2 x 32mm M6 Bolts - 13mm hole



Disabled Accessible AS1428.1

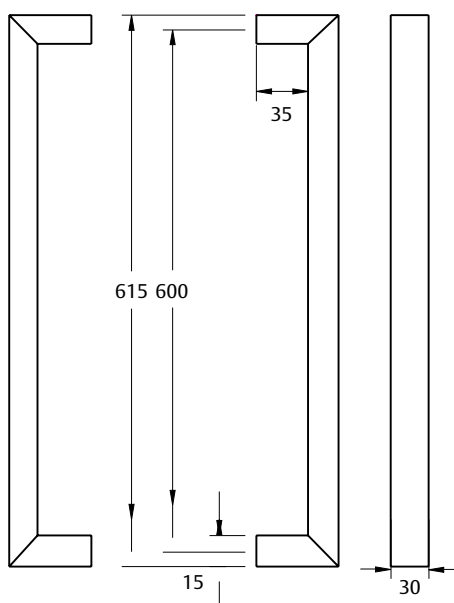

# Velocity® Series Large Rose Door Furniture



The Velocity Series is a stylish range of door furniture suitable for use in residential dwellings.

Designed to suit common door preparations in the Australian market, Velocity is ideal for both new and retrofit applications.

## Retrofitable

Fits majority of doors with 54mm hole.

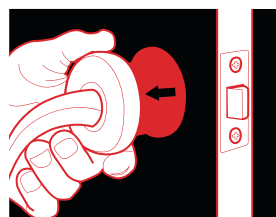

1 Align 2 Twist 3 Tighten



## Features and Specifications

- All fixings are concealed beneath a removable rose trim providing a crisp and clean presentation desired by the discerning home owner
- Simple twist and tighten fixing method with pre-assembled lever set allows for super easy and fast installation
- The rose fits 50mm or 54mm diameter holes making it suitable for retrofit and common door preparations
- Designed in Australia for the specific needs of the Australian market

## Product Details

**Rose Dimensions** 63mm by 12.5mm.

**Materials** Solid zinc die-cast with steel rose trims

**Latches** Passage sets are available with a 60mm backset tubular latch. Privacy sets are supplied with a 60mm backset privacy latch which includes an activating pin for the inside of the door and an external emergency release function. The latch is automatically released when the internal handle is operated and is easily adapted for both open in and open out applications. All latches are supplied with industry standard "D" strikes.

**Door Thickness** 32mm to 45mm hinged doors

**Finishes** Matt Black (MBK)

## Standards and Compliance

**D5** Tested to AS4145.2 2008 for Durability passing D5 - 100,000 cycles.



Tested to AS4145.2 2008 for Neutral Salt Spray, passing C6 - 168 hours.

Not suited to coastal applications

# Velocity® Series Large Rose Door Furniture

## Element™ – Lever 3

<b>Length</b>	122mm
<b>Projection</b>	54.5mm
<b>Finger Clearance</b>	47.5mm

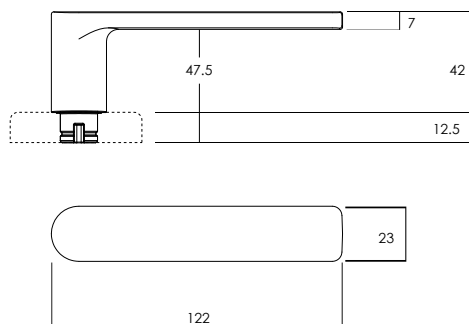

## Passage Leverset

<b>Part Number</b>	VEL1/L3MBK
--------------------	------------

## Dummy Lever

<b>Part Number</b>	VEL3/L3MBK
--------------------	------------

## Privacy Leverset

<b>Part Number</b>	VEL2/L3MBK
--------------------	------------



# Velocity® Series Large Rose Door Furniture

## Square Rose Passage Trim

**Part Number** VES1-TRIMMBK

\* Pack of 2

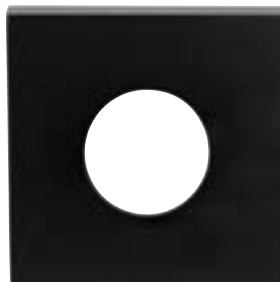

## Square Rose Privacy Trim

**Part Number** VES2-TRIMMBK

\* Pack of 2

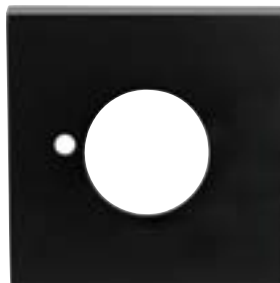



# Velocity® Series Small Rose Door Furniture



The Velocity Small Series is a stylish range of door furniture suitable for both residential and semi-commercial applications. Designed primarily for new installation on timber doors, the range incorporates functionality for use with Mortice Locks in addition to Passage, Privacy and Dummy Levers.

## Installation

Suits door thickness range of 32mm to 45mm.

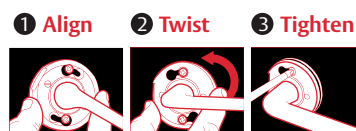
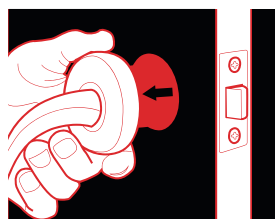

## Features and Specifications

- All fixings are concealed beneath a removable rose trim providing an aesthetically appealing installation
- Simple twist and tighten fixing method with pre-assembled lever set allows for super easy and fast installation
- Choose from two lever designs, the ever popular Element L3 lever and the AS1428.1 compliant Dianella L8 lever
- Accessories include AS1428.1 compliant turn, standard turn and privacy indicating emergency turns
- The 55mm rose suits up to 45mm door thickness commonly used with mortice locks or latches
- Designed in Australia for the specific needs of the Australian market

## Product Details

<b>Rose Dimensions</b>	55mm by 12.5mm - Round Rose 58mm by 12.5mm - Square Rose
<b>Materials</b>	Solid zinc die-cast lever with steel rose trims
<b>Latches</b>	Passage sets are available with a 60mm backset tubular latch. Privacy sets are supplied with a 60mm backset privacy latch which includes a locking pin for the inside of the door and an external emergency release function. The latch is automatically released when the internal handle is operated and is easily adapted for both open in and open out applications. All latches are supplied with industry standard "D" and "T" strikes.
<b>Door Thickness</b>	32mm to 45mm hinged doors
<b>Finishes</b>	Matt Black (MBK)

## Standards and Compliance



Successfully tested up to 2 hours on fire door assemblies in accordance with the Australian Standard AS1905.1 2005 - Part 1: Fire Resistant Doorsets when used with Lockwood Synergy or Selector mortice locks

**D8**

Tested to AS4145.2 2008 for Durability passing D8 - 500,000 cycles



Tested to AS4145.2 2008 for Neutral Salt Spray, passing C6 - 168 hours



AS1428.1 Compliance.  
The range includes AS1428.1 compliant levers and turns

# Velocity® Series Small Rose Door Furniture

## Element™ - Lever 3

<b>Length</b>	122mm
<b>Projection</b>	54.5mm
<b>Finger Clearance</b>	47.5mm

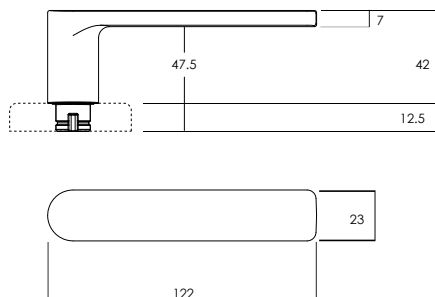

## Mortice Lock Leverset

<b>Part Number</b>	VSR0/L3MBK
--------------------	------------

## Passage Leverset

<b>Part Number</b>	VSR1/L3MBK
--------------------	------------

## Dummy Lever

<b>Part Number</b>	VSR3/L3MBK
--------------------	------------



## Privacy Leverset

<b>Part Number</b>	VSR2/L3MBK
--------------------	------------



# Velocity® Series Small Rose Door Furniture

## Dianella™ - Lever 8

**Length** 121mm

**Projection** 51mm

**Finger Clearance** 38mm



Disabled Accessible  
AS1428.1

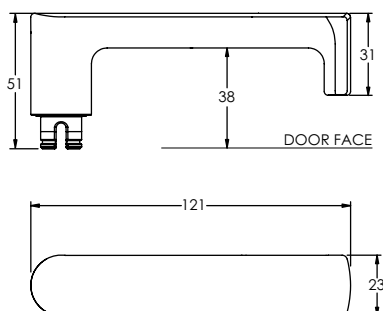

## Mortice Lock Leverset

**Part Number** VSR0/L8MBK

## Passage Leverset

**Part Number** VSR1/L8MBK



## Privacy Leverset

**Part Number** VSR2/L8MBK



# Velocity® Series Small Rose Door Furniture

## Square Rose Passage Trim

**Part Number** VSS1-TRIMMBK

\* Pack of 2

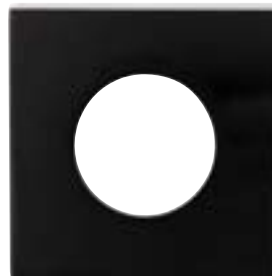

## Square Rose Privacy Trim

**Part Number** VSS2-TRIMMBK

\* Pack of 2



# Velocity® Series Small Rose Door Furniture

## Euro Cylinder Escutcheon

<b>Part Number</b>	VSR5/MBK
<b>Height</b>	55mm
<b>Depth</b>	12.5mm

**Supplied with**  
2x Wood Screws

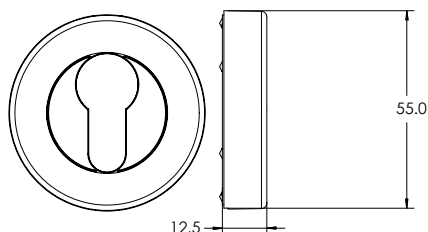

## Oval Cylinder Escutcheon

<b>Part Number</b>	VSR6/MBK
<b>Height</b>	55mm
<b>Depth</b>	12.5mm

**Supplied with**  
2x Wood Screws

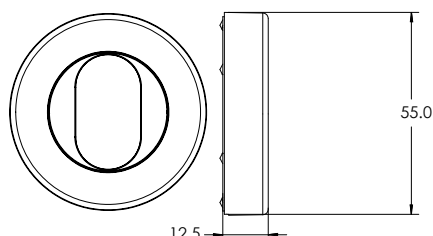

## Standard Turnknob

<b>Part Number</b>	VSR7/MBK
<b>Height</b>	55mm
<b>Depth</b>	12.5mm
<b>Handing</b>	Not required

**Supplied with**  
2x Wood Screws  
1x Short Tail Bar  
1x Medium Tail Bar  
1x Tail Bar Spring  
1x Instructions (1220-321)

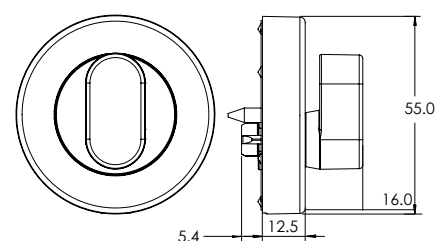

## Privacy Indicating Emergency Turn

<b>Part Number</b>	VSR8/MBK
<b>Height</b>	55mm
<b>Depth</b>	12.5mm

**Supplied with**  
2x Wood Screws  
1x Emergency Tail Bar  
1x Instructions (1220-321)

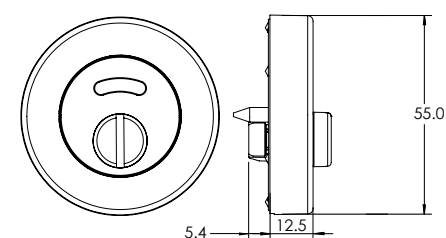

# Velocity® Series Small Rose Door Furniture

## Disabled Accessible Turnknob

Part Number	VSR9/MBK
Height	55mm
Depth	12.5mm
Turn Snib Length	52mm
Handing	Site handable

### Supplied with

- 2x Wood Screws
- 1x Tail Bar (short)
- 1x Tail Bar (medium)
- 1x Tail Bar Spring
- 1x Instructions (1220-321)

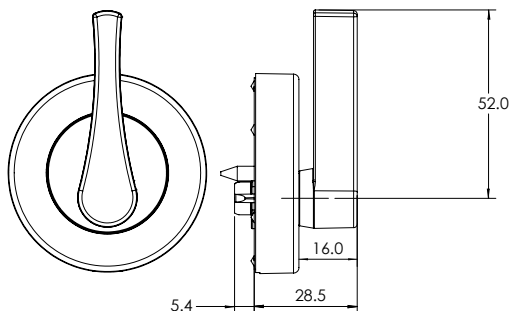

## Square Rose Escutcheon Trim

Part Number	VSS6-TRIMMBK
-------------	--------------

\* Pack of 2

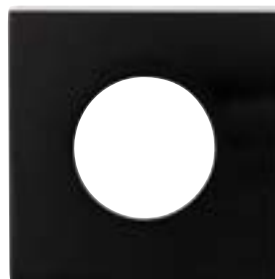

# Cavity Sliding Door Lock



The Lockwood sliding door lock range is possibly the most innovative and aesthetically pleasing lock for a cavity sliding door in Australia. Combining elegance and ease of use, the Lockwood Cavity Sliding Door Lock range is ideal for any home décor and security solution.

Available in entrance, passage and privacy models, it offers the perfect solution for residential bathroom sliding doors.

### Features and Specifications

- Fitted flush against the panel of the sliding door for full recess into the door cavity

#### Retractable door pull

Designed after extensive research, the sliding cavity door lock features an innovative retractable door pull which combines style with functionality.

Product Details	
Cross Drill	25mm
Door Thickness	32* to 40mm for timber doors *Requires spacer ring (included)
Finishes	Matt Black (MBK)
Latch Backset	60mm
Prep Hole	54mm
Strike	Box strike or pip strike (passage)
Materials	Furniture plate: Zinc Alloy Bolt: Nickel Plated Zinc (12.4mm projection) Bolt Beak: Stainless Steel Front End Plate: Stainless Steel Retractable Door Pull: Zinc Plated Strike Plate: Stainless Steel Strike Box: Zinc Plated

# Cavity Sliding Door Lock

## 7400 Privacy Set

Part Number	Finish
7400MBKDP	Matt Black

### Outside

Emergency release button opened by coin or screwdriver

### Inside

Locked or unlocked by turn-plate

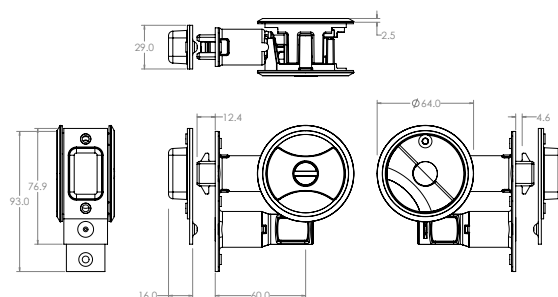

Exterior

Interior

## 7444 Entrance Set

Part Number	Finish
7444MBKDP	Matt Black

### Outside

Locked or unlocked by key

### Inside

Locked or unlocked by turn-plate

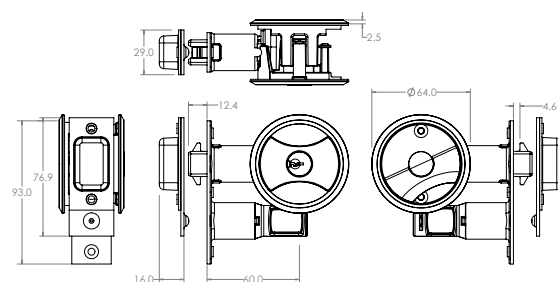

Exterior

Interior

## 7450 Passage Set

Part Number	Finish
7450MBKDP	Matt Black

### Outside

Free to slide door at all times

### Inside

Free to slide door at all times

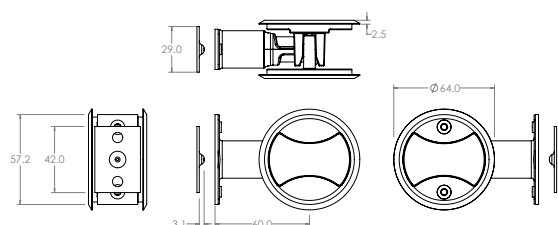

Exterior

Interior



# FP2 Flush Pull



The Lockwood Nero® Flush Pull offers multiple solutions for flush mount door furniture.

## Application

Suited to numerous applications which require the door furniture to be flush with the surface of the door.

## Product Details

<b>Materials</b>	Zinc
	Stainless Steel

## Standards and Compliance

<b>C6</b>	These products have been successfully tested in accordance with AS 2331-3.1: 2001. Neutral Salt Spray Test (NSS TEST). Passing C6 Corrosion Resistance - 168 hours
-----------	--

# FP2 Flush Pull

FP2-150

Dimensions	Packaging	Part Number
------------	-----------	-------------

150 x 50mm	Trade	FP2-150PC
------------	-------	-----------

## Features and Specifications

- Stainless steel flush pull
- Trade packed, complete with fixing screws

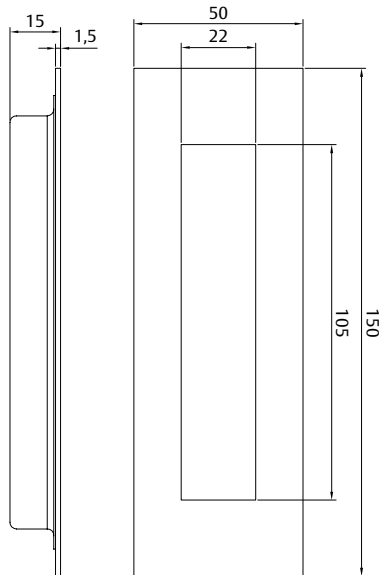

# 724 Series Slide Arm Door Closer



The Lockwood Rack & Pinion Slide Arm Series provides for a cleaner, more aesthetic appearance on the door whilst utilizing the same robust features and benefits of Rack and Pinion functionality.

## Specifications

<b>Power</b>	EN adjustable 2 to 4
<b>Back check (BC)</b>	Adjustable
<b>Hold Open</b>	Adjustable. Hold-open can be set at any angle up to 150° of opening
<b>Handing</b>	Non-handed. Suitable for left or right hand doors
<b>Cover</b>	Clip-on
<b>Materials</b>	Extruded aluminium body manufactured from high-performance silicon alloy
<b>Mechanism</b>	Rack and pinion design
<b>Mounting</b>	Regular, parallel and over-door
<b>Valves</b>	Adjustable closing and latching speed valves with overload protection.

## Standards and Compliance



Tested on fire door assemblies up to 4 hours in accordance with Australian Standard AS1905.1- 1997, Part 1: Fire Resistant Doorsets The Lockwood 724SR series closer has been successfully tested upto four hours (depending on type of doorset) on fire door assemblies in accordance with Australian Standard AS1905.1:2005, Part: Fire Resistant Door sets.

Note: Hold open option is not approved on any fire door.

# 724 Series Slide Arm Door Closer

## 724SR Slide Arm Pull Side

### Part Numbers

724SRBLK

Closer installed on pull side of door. This mounting position permits opening of 130°.

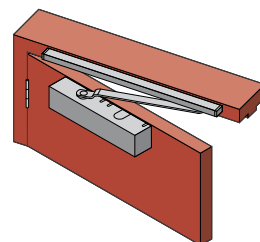
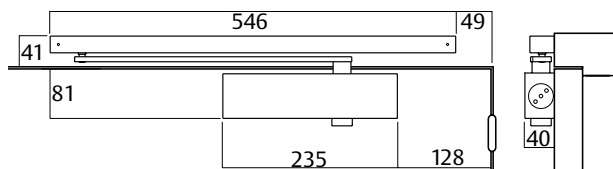

## 724SR Slide Arm Push Side

### Part Numbers

724SRBLK

Closer installed on push side of door. This mounting position permits opening of 115°.

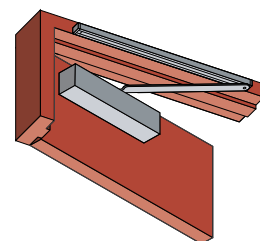
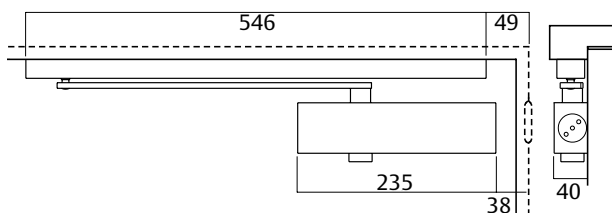

## 724SR Slide Arm Over Door Mounting Push Side

### Part Numbers

724SRBLK

Closer installed on push side of door and top rail where conditions do not allow parallel mounting. This mounting position permits opening of 115°.

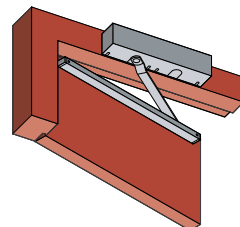
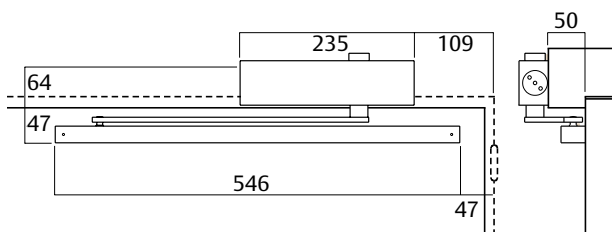

# Nexion® Mechanical Entrance Lockset



The Nexion Entrance Lockset represents the next generation in home security.

Designed and manufactured to the highest standards of quality, the Lockwood Nexion has set the benchmark for safety, security and style. The Nexion offers the ultimate protection for your home and family.

## Features and Specifications

- Three mode security: Secure, Safety and Passage mode provides excellent security without compromising convenience
- LockAlert® indicator shows lock status at a glance
- SafetyRelease™ automatically unlocks the inside handle upon entry to minimise the risk of being locked in
- High security latch
- Box strike with concealed crossgrain door frame strengthening screw
- Can be keyed alike to other Lockwood door locks as well as builder's key systems

## Product Details

<b>Backset</b>	60mm as supplied 70mm optional (order part 530-222SC)
<b>Case</b>	High purity zinc alloy
<b>Door Thickness</b>	35 to 45mm
<b>Finishes</b>	Matt Black (MBK)
<b>Handles</b>	Element Lever 3
<b>Latch</b>	13mm projection brass bolt
<b>Strike</b>	Box strike with concealed crossgrain door frame strengthening screw
<b>Templates</b>	Installation template included
<b>Handing</b>	Adjustable handing by set screw
<b>Cylinder</b>	Internal and external 5 pin tumbler mechanism with 6 pin capability Brass cylinders and brass barrels

## Standards and Compliance



The locksets can be optioned to suit fire door sets with a fire resistance level of up to 1 hour on fire door assemblies in accordance with Australian Standard AS1905.1:2005 Fire Resistant Doorsets. The fire rated option is achieved with a standard Nexion Vision Entrance Lockset and the optional fire rated kit (order NXVFRKIT).

**SL7**

(Security) Australian Lock Standard (AS4145.2:2008)

**D8**

(Durability) Australian Lock Standard (AS4145.2:2008)

**C5**

(Corrosion) Australian Lock Standard (AS4145.2:2008)



CE Approved



C-tick certified

# Nexion® Mechanical Entrance Lockset

## Keying

- Supplied individually keyed with two keys per lock
- 78,000 key combinations
- Key blank KB2015P

### Restricted Special Keying

Lockwood locks can be keyed to a number of controlled and/or specially keyed systems. These range from legally protected keys to protect against unauthorised duplication, which can also include specially designed key systems such as master key systems, which allow for different levels of mechanical access control.

Please refer to Lockwood Keying Catalogue or contact your local sales office or customer service for specific information.

## Latch Dimensions

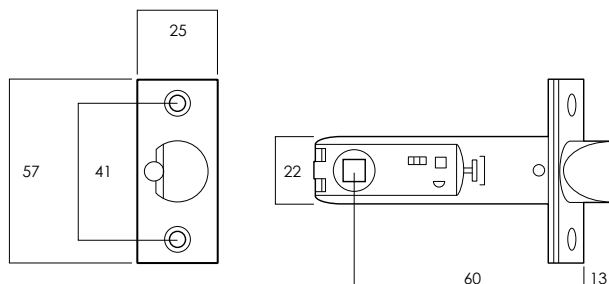

**Kinetic Defence®**  
Bump and pick resistant.



**Deadlatch Bolt**  
13mm projection  
brass bolt.



**SafetyRelease™**  
Minimises the risk of being  
locked in.



**2 Keys Included**  
Can be keyed alike to other  
Lockwood door locks.



**LockAlert®**  
Interior Indicator shows lock  
status at a glance.



**Quick Installation**  
Suitable for door thicknesses  
between 35–45mm.



**Safety Mode**  
Securely locked from outside  
and free from inside.



**Retrofittable**  
Fits majority of doors with  
54mm hole.



**Secure Mode**  
Securely locked from both  
inside and outside. For when  
nobody is home.



**Passage Mode**  
Free to enter from outside  
and free to exit from inside.

# Nexion® Mechanical Entrance Lockset

## Nexion Vision - Double Cylinder



Exterior

Interior

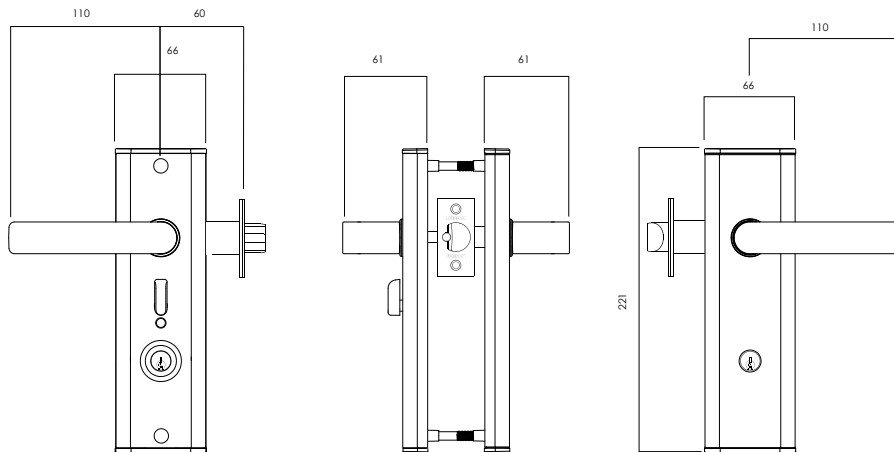

# Nexion® Mechanical Entrance Lockset

## Ordering Procedure

Series	Function	Cylinders	App. Options	Levers	Finish	Keying
NXV	1	2	1	L3	MBK	-

Series	Cylinders	Levers	Keying
Nexion Vision NXV	Double 2	Element L3	Keyed to Differ (Standard) -
Function	Application Options	Finish	Keyed Alike 5 Pins 5KA
Mechanical 1	Timber Frame Strike* 1	Matt Black MBK	Project Keyed 5 Pins 5PK
			Restricted Profile 5 Pins 5RP
			Keyed Alike 6 Pins 6KA
			Project Keyed 6 Pins 6PK

\* Metal Frame T-Strike optional  
(order part NX8/40SC)

\* For Fire Rated Nexion Vision option  
(order part NXVFRKIT)



# Paradigm® 005 Cylinder Deadbolt



The Paradigm® 005 Double Cylinder Deadbolt is the premium security solution with its innovative safety features. The contemporary styling can be combined with any lever or entrance handle to create an elegant security solution, ideal for residential and architectural applications.

## Key Features

- Three function modes with DualSelect® provides combination of convenience and security
- High security cut resistant stainless steel bolt
- Safety Release™ automatically unlocks internal knob upon key entry from outside
- LockAlert® indicator shows lock status at a glance
- Available in round or square rose

## Restricted Special Keying

Lockwood locks can be keyed to a number of controlled and/or specially keyed systems. These range from legally protected keys to protect against unauthorised duplication, which can also include specially designed key systems such as master key systems, which allow for different levels of mechanical access control.

Please refer to Lockwood Keying Catalogue or contact your local sales office or customer service for specific information.

## Retrofitable

Replace your existing Deadbolt. Fits 54mm hole. 60-70mm adjustable backset. 32-48mm door thickness.

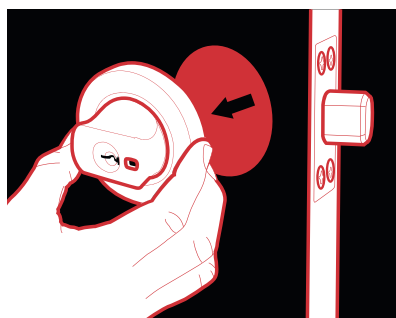

## Product Details

<b>Backset</b>	60 to 70mm adjustable stainless steel bolt
<b>Bolt</b>	High security, cut resistant stainless steel bolt
<b>Cylinder</b>	5 pin tumbler mechanism Brass cylinder and brass barrel
<b>Door Thickness</b>	32–48mm 32–36mm doors require a spacer (Included)
<b>Finishes</b>	Matt Black (MBK)
<b>Keying</b>	Supplied individually keyed with two keys per lock, 78,000 key combinations, Key blank KB2015P
<b>Materials</b>	High purity zinc alloy
<b>Strike</b>	Box strike with concealed crossgrain door frame strengthening screw

## Standards and Compliance

<b>SL8</b>	(Security) Australian Lock Standard (AS4145.2 - 2008)
<b>D8</b>	(Durability) Australian Lock Standard (AS4145.2 - 2008)
<b>C6</b>	(Corrosion) Australian Lock Standard AS4145.2 - 2008)
<b>K5</b>	(Key Security) Australian Lock Standard AS4145.2 - 2008)

# Paradigm® 005 Cylinder Deadbolt

## Round Rose



Exterior



Interior

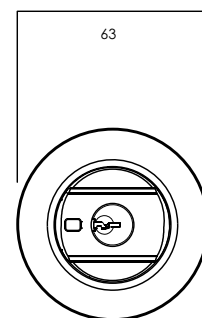
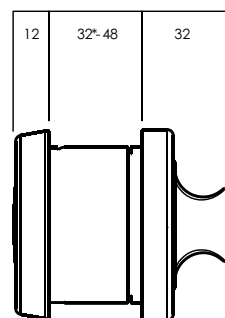
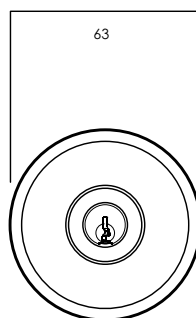

\*32–36mm door thickness requires spacer ring (included)



**Kinetic Defence®**  
Bump and pick resistant.



**Counterbalance Bolt**  
Proportionally distributes the load between the door and door frame.



**DualSelect®**  
Turn the key for safety mode. Turn the key further to select secure mode.



**2 Keys Included**  
Can be keyed alike to other Lockwood door locks.



**SafetyRelease™**  
Minimises the risk of being locked in.



**Retrofitable**  
Replace your existing Deadbolt. Fits 54mm hole. 60-70mm adjustable backset. 32-48mm door thickness.



**Anti-Corrosion**  
Successfully tested in accordance with AS2332.3.1:2001 neutral salt spray test.



**LockAlert®**  
Interior Indicator shows lock status at a glance.



**Safety Mode**  
Securely locked from outside and free from inside.



**Secure Mode**  
Securely locked from both inside and outside. For when nobody is home.



**Passage Mode**  
Free to enter from outside and free to exit from inside.

# Paradigm® 005 Cylinder Deadbolt

## Square Rose



Exterior



Interior

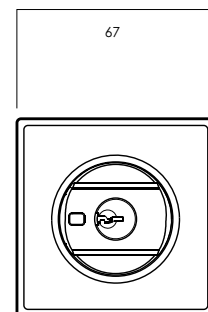
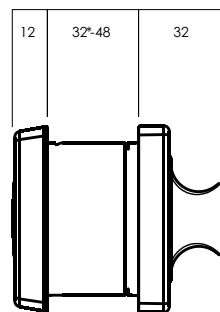
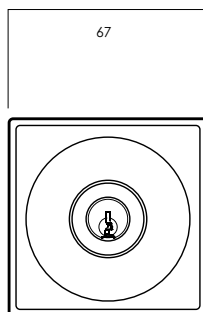

\*32–36mm door thickness requires spacer ring (included)



**Kinetic Defence®**  
Bump and pick resistant.



**Counterbalance Bolt**  
Proportionally distributes the load between the door and door frame.



**DualSelect®**  
Turn the key for safety mode. Turn the key further to select secure mode.



**2 Keys Included**  
Can be keyed alike to other Lockwood door locks.



**SafetyRelease™**  
Minimises the risk of being locked in.



**Retrofiable**  
Replace your existing Deadbolt. Fits 54mm hole. 60-70mm adjustable backset. 32-48mm door thickness.



**Anti-Corrosion**  
Successfully tested in accordance with AS2332.3.1:2001 neutral salt spray test.



**LockAlert®**  
Interior Indicator shows lock status at a glance.



**Safety Mode**  
Securely locked from outside and free from inside.



**Secure Mode**  
Securely locked from both inside and outside. For when nobody is home.



**Passage Mode**  
Free to enter from outside and free to exit from inside.

# Paradigm® 005 Cylinder Deadbolt

## Ordering Procedure

Series	Type	Rose Style	Finish	Packaging	Keying
005	B	1	MBK	DP	

Series	Rose Style	Packaging	please contact customer service.
Paradigm® Deadbolt 005	Round 1	Universal Pack DP	
	Square 2	Trade Pack	

Type	Finish	Keying Options
Bolt B	Matt Black MBK	Special Keying-Residential Keyed Alike 5P 5KA
		Keyed Alike 6P 6KA
		Project Keyed 5P 5PK
		Project Keyed 6P 6PK
		Restricted Profile 5P 5RP

\* For keying options

# Symmetry® Leverset

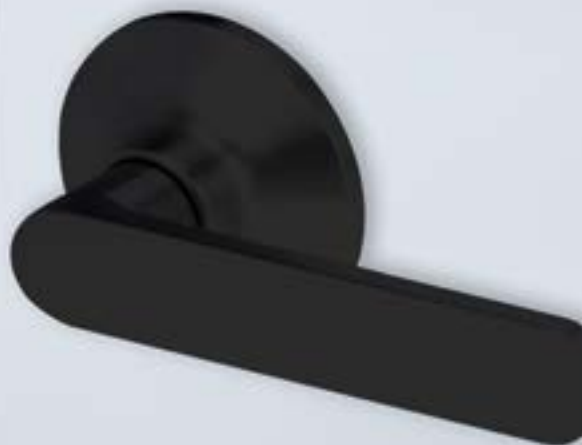

The Symmetry door handle range offers builders, developers, specifiers and interior designers a wide selection of product that can be used in any residential application

The Symmetry series is produced to meet the demanding quality and style requirements of the Australian market.

All products are tested in accordance with the security and durability requirements of the Australian Standards.

Along with the Lockwood 25 year Mechanical Warranty all Symmetry door furniture is supplied with a 5 year finish Guarantee with the exception of the Everbrass finish which has a 25 year finish Guarantee.

## Keying

### Standard Keying

- Supplied individually keyed with three keys per lock
- 78,000 key combinations
- Key blank KB2015P

### Restricted Special Keying

Lockwood locks can be keyed to a number of controlled and/or specially keyed systems. These range from legally protected keys to protect against unauthorised duplication, which can also include specially designed key systems such as master key systems, which allow for different levels of mechanical access control. Please refer to Lockwood Keying Catalogue or contact your local sales office or customer service for specific information.

### Product Details

<b>Backset</b>	60 to 70mm adjustable latch standard
<b>Cylinder</b>	5 pin Lockwood C4 brass cylinder assembly (6 pin compatible)
<b>Functions</b>	Entrance, privacy, passage and dummy available
<b>Handing</b>	Suitable for left and right handed doors
<b>Installation</b>	Easy to install with detailed mounting instructions
<b>Latch</b>	13mm throw
<b>Strike</b>	D-strike with anti-rattle tab as standard

### Symmetry 5 Year Finish Guarantee



Lockwood guarantees to replace Symmetry product if within five years from the proven date of purchase it tarnishes, discolours or corrodes when properly installed and subject to no more than fair wear and tear.

### 1 ONECYL®

The exclusive one cylinder assembly solution 'OneCyl®' has been designed for the entire Lockwood Symmetry Range, which grants the convenience of cylinder interchangeability.

# Symmetry® Leverset

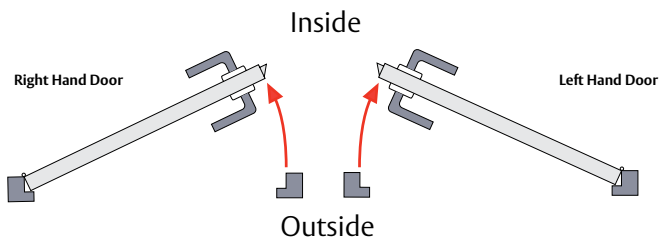

## Symmetry® – Element™ Series

Part Numbers	Function
7550MBK	Entrance
7551MBK	Passage
7552MBK	Privacy
7555MBK	Dummy

## Symmetry® – Element™ Leverset

<b>Type</b>	Tubular Latch
<b>Materials</b>	<b>Key in Lever:</b> Zinc Alloy <b>Chassis:</b> Steel <b>Bolt head:</b> Zinc
<b>Fixing</b>	Horizontal mounting screw fixing
<b>Door Thickness</b>	35–45mm for timber doors
<b>Finish</b>	Matt Black
<b>Packaging</b>	Trade Pack only available

# Symmetry® Leverset

## Ordering Procedure

Locksets Series	Function	Finish	Packaging	Keying
755	0	MBK		KA
Lockset Series	Function	Finish	Packaging	Keying
Element™ 755	Entrance 0 Passage 1 Privacy 2 Dummy 5	Matt Black MBK	Trade Pack TP	Special Keying-Residential Keyed Alike 5P 5KA Keyed Alike 6P 6KA Project Keyed 5P 5PK Projected Keyed 6P 6PK Restricted Profile 5P 5RP



**Lockwood** is the leading brand in the Australian locking industry. With an established reputation for high quality products, this iconic brand provides a wide range of locking solutions to residential housing, commercial, semi-commercial, building and industrial application markets. Lockwood is supported by an extensive distribution and after-sales support network. Our customers include retailers, architects, trade and industrial personnel, locksmiths and security dealers.

**ASSA ABLOY** is the global leader in door opening solutions, dedicated to satisfying end-user needs for security, safety and convenience.

**ASSA ABLOY** is represented in all major regions, in both mature and emerging markets, with leading positions in Australia, Europe and North America.



### **The Lockwood 25 Year Mechanical Warranty**

Our belief that we manufacture the finest premium products available in today's market place is backed by the Lockwood 25 Year Mechanical Warranty, ensuring that Lockwood continues to keep Australians safe by delivering security and peace of mind.

For warranty terms and conditions, please visit [www.lockweb.com.au](http://www.lockweb.com.au) or call **1300WARRANTY**

**ASSA ABLOY Opening Solutions Australia**  
235 Huntingdale Road  
Oakleigh, Victoria, 3166  
Australia

**1300 LOCK UP (1300 562 587)**  
[lockweb.com.au](http://lockweb.com.au)

**ASSA ABLOY New Zealand Ltd**  
6 Armstrong Road  
Albany, Auckland, 0632  
New Zealand

[info.nz@assaabloy.com](mailto:info.nz@assaabloy.com)  
Telephone +64 9415 7111  
[assaabloy.co.nz](http://assaabloy.co.nz)

### **Disclaimer**

Whilst every effort has been made to ensure that the information (including product images and drawings) contained in this brochure is accurate at the time of publication, ASSA ABLOY Australia Pty Limited ("ASSA ABLOY") recommends that you consult ASSA ABLOY or its agents prior to placing an order to ascertain current information on specific products, as ASSA ABLOY reserves the right to make changes without notice. ASSA ABLOY will not be liable for any injury, loss or damage whatsoever, arising from any errors or omissions in the information contained in the brochure or arising from the use or application of the information contained herein. © 2020 copyright by ASSA ABLOY All rights reserved

