

# Velocity® Series Small Rose Door Handles



The Velocity 55mm Series is a stylish range of door furniture suitable for both residential and semi commercial applications. Designed primarily for new installation on timber doors, the range incorporates functionality for use with Mortice Locks in addition to Passage, Privacy and Dummy Levers.

## Installation

Suits door preparations up to 45mm.

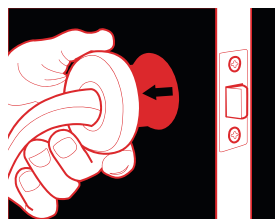

1 **Align** 2 **Twist** 3 **Tighten**



## Features and Specifications

- All fixings are concealed beneath a removable rose trim providing an aesthetically appealing installation.
- Simple twist and tighten fixing method and pre-assembled lever sets allow for super easy and fast installation.
- Lever range includes two AS1428.1 compliant levers and six designer levers.
- Accessories include AS1428.1 compliant turn, standard turn and privacy indicating emergency turns.
- The 55mm rose suits up to 45mm door preparations commonly used with mortice locks or latches.
- Designed in Australia for the specific needs of the Australian market.

## Product Details

<b>Rose Dimensions</b>	55mm by 12.5mm - Round Rose 58mm by 12.5mm - Square Rose
<b>Materials</b>	All Velocity 55mm levers and roses are made from solid zinc die-cast.
<b>Latches</b>	Passage sets are available with a 60mm backset tubular latch. Privacy sets are supplied with a 60mm backset privacy latch which includes a locking pin for the inside of the door and an external emergency release function. The latch is automatically released when the internal handle is operated and is easily adapted for both open in and open out applications. All latches are supplied with industry standard "D" strikes.
<b>Door Thickness</b>	32mm to 45mm hinged doors
<b>Finishes</b>	Satin Chrome Brushed (SC) Chrome Plate (CP) Satin Pearl (SP) Display Pack Range Only

## Standards and Compliance



Successfully tested up to 2 hours on fire door assemblies in accordance with the Australian Standard AS1905.1 2005 - Part 1: Fire Resistant Doorsets

**D8**

VEL Series lever sets have been successfully tested to conform with Level D8 (500,000 cycles) under Australian Standard AS4145.2-2008, Locksets and hardware for doors and windows.



VEL Series in brushed satin chrome finish has been successfully tested to conform with Level C10 (1000 hours) under Australian Standard AS4145.2-2008, Locksets and hardware for doors and windows.



AS1428.1 Compliance. The range includes AS1428.1 compliant levers and turns as shown.

# Velocity® Series Small Rose Door Handles

## AS1428.1 Compliant Levers

### Accession® - Lever 5

**Length** 121mm

**Projection** 56.5mm

**Finger Clearance** 38.4mm



Disabled Accessible  
AS1428.1

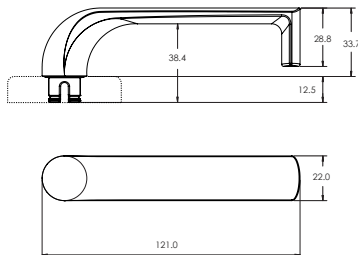

### Dianella™ - Lever 8

**Length** 121mm

**Projection** 51mm

**Finger Clearance** 38mm



Disabled Accessible  
AS1428.1

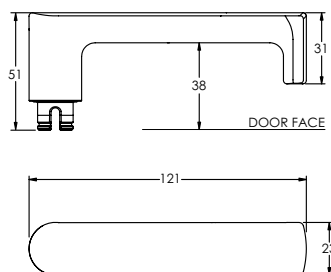

### Gidgee® - Lever 37

**Length** 120mm

**Projection** 64mm

**Finger Clearance** 38.5mm



Disabled Accessible  
AS1428.1

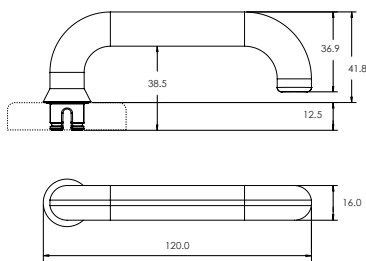

## Standard Levers

### Element™ - Lever 3

**Length** 122mm

**Projection** 54.5mm

**Finger Clearance** 47.5mm

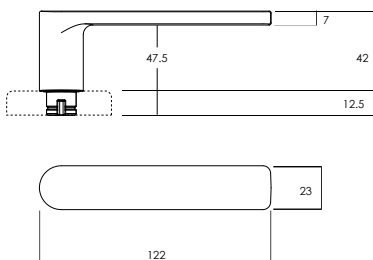

# Velocity® Series Small Rose Door Handles

## Standard Levers

### Hakea® - Lever 28

<b>Length</b>	121mm
<b>Projection</b>	63mm
<b>Finger Clearance</b>	43mm

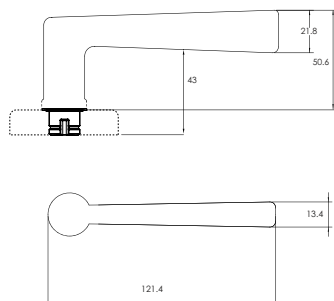

### Acacia® - Lever 29A

<b>Length</b>	120mm
<b>Projection</b>	64mm
<b>Finger Clearance</b>	41.5mm

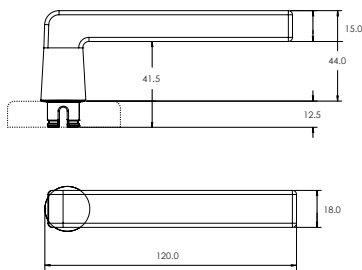

### Saltbush® - Lever 34

<b>Length</b>	120mm
<b>Projection</b>	64mm
<b>Finger Clearance</b>	43.5mm

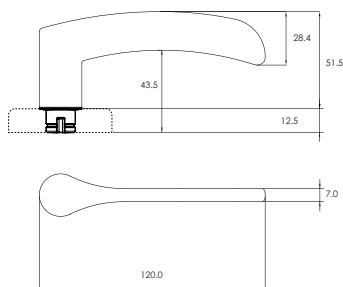

# Velocity® Series Small Round Rose Accessories

## Euro Cylinder Escutcheon

<b>Part Number</b>	VSR5
<b>Height</b>	55mm
<b>Depth</b>	12.5mm

**Supplied with**  
2x Wood Screws

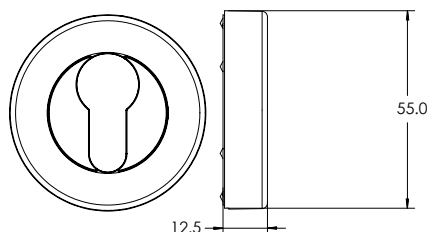

## Oval Cylinder Escutcheon

<b>Part Number</b>	VSR6
<b>Height</b>	55mm
<b>Depth</b>	12.5mm

**Supplied with**  
2x Wood Screws

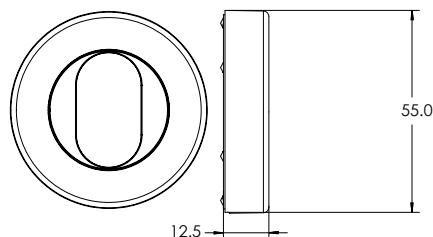

## Standard Turnknob

<b>Part Number</b>	VSR7
<b>Height</b>	55mm
<b>Depth</b>	12.5mm
<b>Handing</b>	Not required

**Supplied with**  
2x Wood Screws  
1x Short Tail Bar  
1x Medium Tail Bar  
1x Tail Bar Spring  
1x Instructions (1220-321)

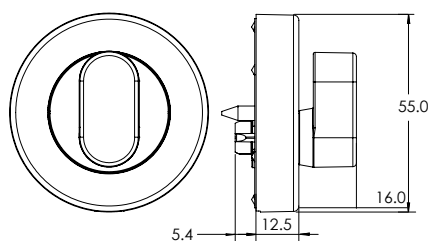

## Privacy Indicating Emergency Turn

<b>Part Number</b>	VSR8
<b>Height</b>	55mm
<b>Depth</b>	12.5mm

**Supplied with**  
2x Wood Screws  
1x Emergency Tail Bar  
1x Instructions (1220-321)

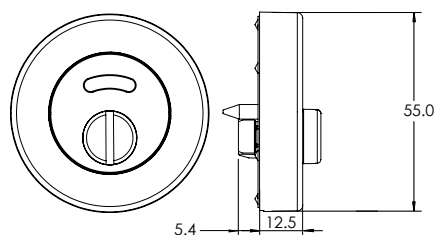

# Velocity® Series Small Round Rose Accessories

## Disabled Accessible Turnknob

<b>Part Number</b>	VSR9
<b>Height</b>	55mm
<b>Depth</b>	12.5mm
<b>Turn Snib Length</b>	52mm
<b>Handing</b>	Site handable

### Supplied with

2x Wood Screws  
1x Tail Bar (short)  
1x Tail Bar (medium)  
1x Tail Bar Spring  
1x Instructions (1220-321)

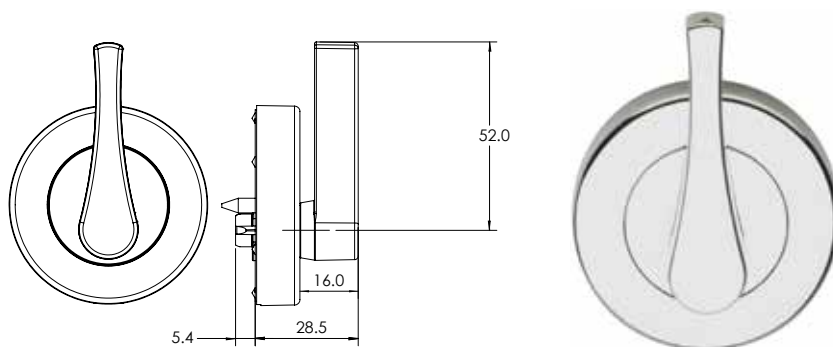

\* VSR9 is not compatible with Selector series mortice locks.

## Round Rose Passage Trim

<b>Part Number</b>	VSR1-TRIM
<b>Height</b>	55mm
<b>Depth</b>	12.5mm
<b>Quantity</b>	Pack of 2

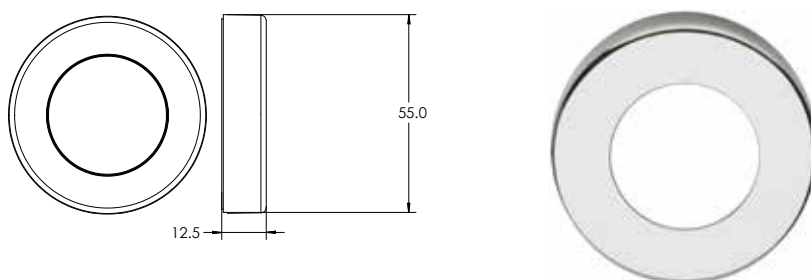

## Round Rose Privacy Trim

<b>Part Number</b>	VSR2-TRIM
<b>Height</b>	55mm
<b>Depth</b>	12.5mm
<b>Quantity</b>	Pack of 2

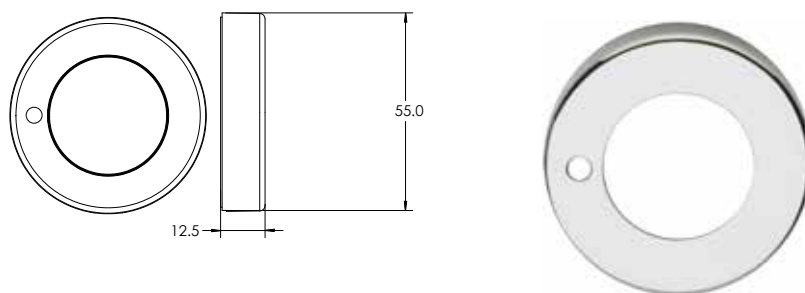

# Velocity® Series Small Square Rose Accessories

## Euro Cylinder Escutcheon

<b>Part Number</b>	VSS5
<b>Height</b>	58mm
<b>Depth</b>	12.5mm

**Supplied with**  
2x Wood Screws

**Note:** Please ensure clearance between lever trim and escutcheons when used with European Mortice Locks.

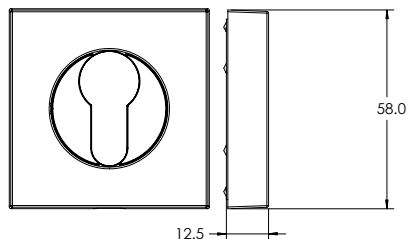

## Oval Cylinder Escutcheon

<b>Part Number</b>	VSS6
<b>Height</b>	58mm
<b>Depth</b>	12.5mm

**Supplied with**  
2x Wood Screws

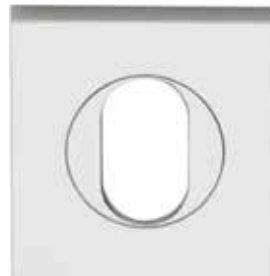
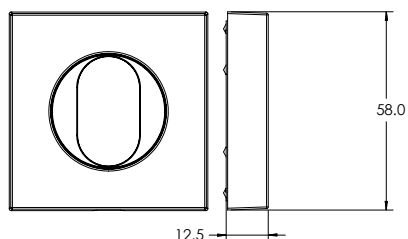

## Standard Turn Snib

<b>Part Number</b>	VSS7
<b>Height</b>	58mm
<b>Depth</b>	12.5mm
<b>Handing</b>	Not required

**Supplied with**  
2x Wood Screws  
1x Short Tail Bar  
1x Medium Tail Bar  
1x Tail Bar Spring  
1x Instructions (1220-321)

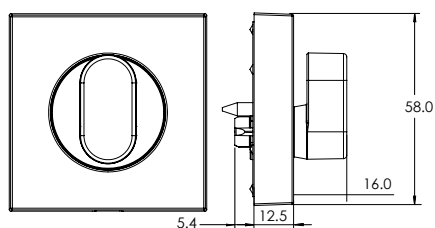

## Emergency Indicating Turn

<b>Part Number</b>	VSS8
<b>Height</b>	58mm
<b>Depth</b>	12.5mm
<b>Handing</b>	Not required

**Supplied with**  
2x Wood Screws  
1x Emergency Tail Bar  
1x Instructions (1220-321)

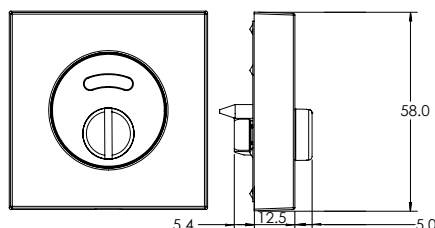

# Velocity® Series Small Square Rose Accessories

## Disabled Accessible Turn Snib

<b>Part Number</b>	VSS9
<b>Height</b>	58mm
<b>Depth</b>	12.5mm
<b>Turn Snib Length</b>	52mm
<b>Handing</b>	Site handable

### Supplied with

2x Wood Screws  
1x Tail Bar (short)  
1x Tail Bar (medium)  
1x Tail Bar Spring  
1x Instructions (1220-321)

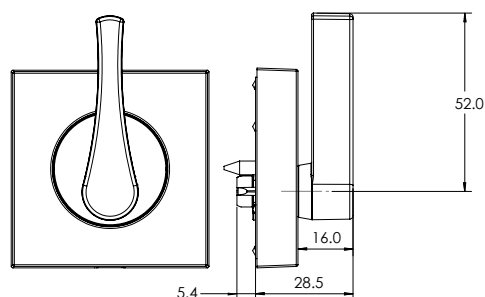

\* VSS9 is not compatible with Selector series mortice locks.

## Square Rose Passage Trim

<b>Part Number</b>	VSS1-TRIM
<b>Height</b>	58mm
<b>Depth</b>	12.5mm
<b>Quantity</b>	Pack of 2

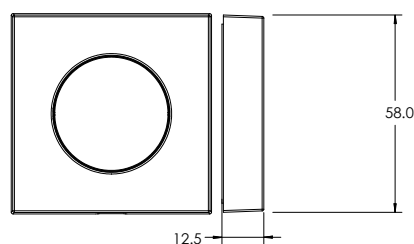

## Square Rose Privacy Trim

<b>Part Number</b>	VSS2-TRIM
<b>Height</b>	58mm
<b>Depth</b>	12.5mm
<b>Quantity</b>	Pack of 2

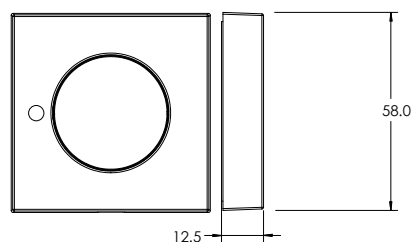

# Velocity® Series Rose Door Handles

Sample part number VSR1/L3SC is made up of several sections. Choose your product by selecting an option from each section.

## Velocity® Small Rose Series - Trade Pack Range

Exterior Rose	Function	Lever Types	Finish		
VSR	1	L3	SC		

Rose Type	Function	Levers	Finish	Packaging
Velocity 55mm Round Rose VSR	Mortice 0	Summit® L1	Satin Chrome Brushed SC	Trade Pack
Velocity 58mm Square Rose VSS	Passage 1	Element™ L3	Chrome Plate CP	
	Privacy 2	Glide™ L4	Matt Black MBK	
	Dummy Half 3	Hakea® 28		
	Euro Escutcheon 5	Acacia® 29A		
	Oval Escutcheon 6	Saltbush® 34		
	Standard Turnknob 7			
	Privacy Indicating Emergency Turn 8			
	Disabled Accessible Turnknob 9			
		AS1428.1 Compliant Levers		
		Accession® L5		
		Dianella™ L8		
		Gidgee® 37		

**Note:** Mortice, Passage, Privacy and Dummy Half Lever Sets only available in Round Rose. See below for ordering procedure

## Velocity® Small Rose Series - Display Pack Range

Rose Type	Function	Lever Types	Finish	Packaging
VSR	1	L3	SC	DP

Rose Type	Function	Levers	Finish	Packaging
Velocity 55mm Round Rose VSR	Passage 1	Summit® L1	Satin Chrome Pearl SP	Display DP
	Privacy 2	Spire® L2	Chrome Plate CP	
		Element™ L3	Satin Chrome Brushed SC	
		Glide™ L4		

### Square Rose Ordering Procedure

Function	Satin Chrome Finish	Chrome Plate Finish	Satin Pearl Finish	Matt Black Finish
Mortice Lever Set				
Passage Lever Set	VSS1-TRIMSC	VSS1-TRIMCP	VSS1-TRIMSP	VSS1-TRIMMBK
Dummy Half Set				
Privacy Lever Set	VSS2-TRIMSC	VSS2-TRIMCP	VSS2-TRIMSP	VSS2-TRIMMBK

Square Rose Lever Sets are ordered in the same manner as Round Rose Lever Sets above with the addition of a Square Rose Trim Pack. For example a Mortice Lever Set, Lever 5 in Satin Chrome will require both VSR0/L5SC and VSS1-TRIMSC.





**Lockwood** is the leading brand in the Australian locking industry. With an established reputation for high quality products, this iconic brand provides a wide range of locking solutions to residential housing, commercial, semi-commercial, building and industrial application markets. Lockwood is supported by an extensive distribution and after-sales support network. Our customers include retailers, architects, trade and industrial personnel, locksmiths and security dealers.

**ASSA ABLOY** is the global leader in door opening solutions, dedicated to satisfying end-user needs for security, safety and convenience.

**ASSA ABLOY** is represented in all major regions, in both mature and emerging markets, with leading positions in Australia, Europe and North America.



### **The Lockwood 25 Year Mechanical Warranty**

Our belief that we manufacture the finest premium products available in today's market place is backed by the Lockwood 25 Year Mechanical Warranty, ensuring that Lockwood continues to keep Australians safe by delivering security and peace of mind.

For warranty terms and conditions, please visit [www.lockweb.com.au](http://www.lockweb.com.au) or call **1300WARRANTY**

**ASSA ABLOY Opening Solutions Australia**  
235 Huntingdale Road  
Oakleigh, Victoria, 3166  
Australia

**1300 LOCK UP (1300 562 587)**  
[lockweb.com.au](http://lockweb.com.au)

**ASSA ABLOY New Zealand Ltd**  
6 Armstrong Road  
Albany, Auckland, 0632  
New Zealand

[nzsales@assaabloy.com](mailto:nzsales@assaabloy.com)  
Telephone +64 9415 7111  
[assaabloyopeningsolutions.nz](http://assaabloyopeningsolutions.nz)

### **Disclaimer**

Whilst every effort has been made to ensure that the information (including product images and drawings) contained in this brochure is accurate at the time of publication, ASSA ABLOY Australia Pty Limited ("ASSA ABLOY") recommends that you consult ASSA ABLOY or its agents prior to placing an order to ascertain current information on specific products, as ASSA ABLOY reserves the right to make changes without notice. ASSA ABLOY will not be liable for any injury, loss or damage whatsoever, arising from any errors or omissions in the information contained in the brochure or arising from the use or application of the information contained herein. © 2020 copyright by ASSA ABLOY All rights reserved

